

Making bobbins with paper inserts

Cut 1/8 inch wooden dowels into 4 inch lengths (Fig 1). Glue a plastic pony bead at one end. Slide and glue another bead 1 inch down from that. This is the area the thread is loaded (Fig 2). On the other end of the dowel, glue 1 pony bead one quarter of an inch up from the base of the dowel. This is to accommodate the spangle to add weight (Fig 3). Cut a piece of decorative paper that measures the length from bottom bead to the collar bead. This paper can be from a magazine, to wall paper, to anything you find that has a pleasing color and pattern. Cut a good length so that when it is rolled up that it will be the same thickness and width as the beads. Glue one edge of the paper to the shaft of the dowel. (Fig 4) Tightly roll the paper around the dowel. Trim off excess and glue the end seam. (Fig 5)

Spangling bobbins

Drill a tiny hole for the wire to pass through (Fig 6). With a fine gauge wire (ex. 28-30 wt), string an even amount of glass beads (Fig 7). This is personal preference on what type. Just so it has good weight. Be creative! String one end of the wire through the hole of the bobbin. String the other end through the hole going the opposite direction (Fig 8). Pull on both tail ends of the wire to tighten. Wrap the wire end tightly to the small space left near the bobbin base at the hole. Tuck the remaining tail end through the hole of the first bead. Clip excess. (Fig 9)

Fig. 1

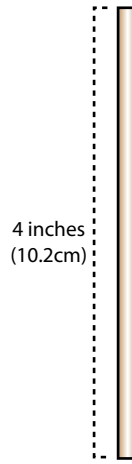

Fig. 2

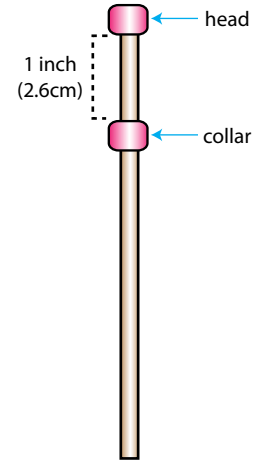

Fig. 3

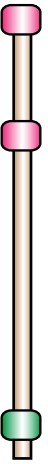

Fig. 4

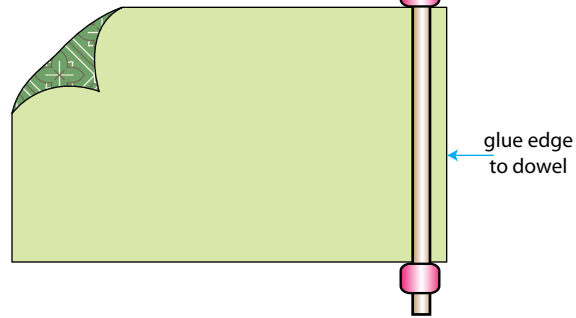

Fig. 5

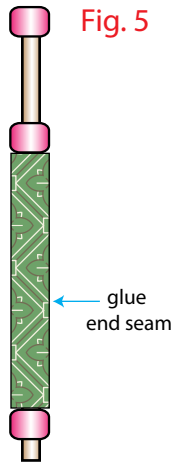

Fig. 8

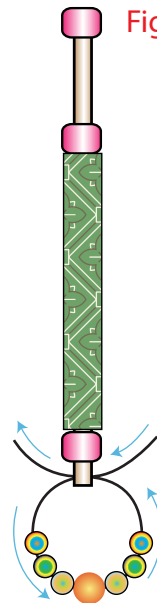

Fig. 9

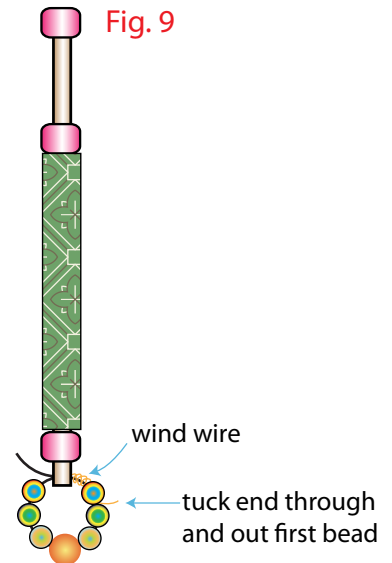
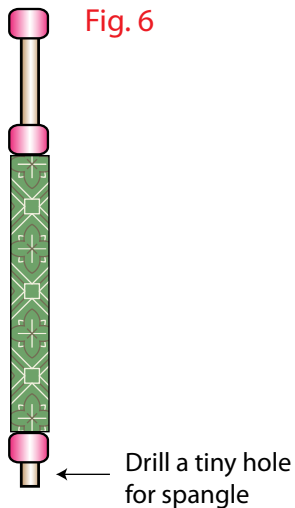

Fig. 6



Drill a tiny hole for spangle

Fig. 7



Let's hop over to get started making lace!

